

CorkSport Carbon Fiber Spoiler

2010-2013 Mazdaspeed 3



Thank you for purchasing the CorkSport Mazdaspeed 3 Carbon Fiber Spoiler. Give your Mazdaspeed's rear end a visual boost. Engineered for a perfect fit for the 2010 - 2013 Mazdaspeed 3.

Please let us know what you think of them by providing feedback here:

<http://corksport.com/2010-2013-mazdaspeed-3-carbon-fiber-spoiler.html>

Pre-Installation Notes:



Note - The carbon fiber products are hand-crafted FRP with carbon overlay, thus, no two items are identical. Small imperfections such as wavy weaves, small bubbles, and clear coat blemishes are inevitable.



Carbon fiber products are durable, but still need standard care and maintenance to continue looking good. Keep it clean and minimize exposure in the sun and wax as necessary. We recommend a final clear coat to this product to protect it from the elements.



These instructions were written for reference only and the use of a factory service manual is recommended. Please read these instructions thoroughly prior to starting installation



These installation instructions were written using a 2013 Mazdaspeed 3. Other year Mazdaspeed3 models will be similar.

Materials and Time:



General Info.

Part #: AXL-8-821
Time Est: 30 minutes
Wrench Rating: 2/5



Tooling List

10mm deep Socket
3/8" Drive Ratchet
Flathead Screw Driver
Phillips Screw Driver
Torque Wrench



Parts List

One (1) CorkSport Carbon Fiber Spoiler
Package of Hardware
3ft of 3M double sided tape

Need Help With Your Installation?
Call (360) 260-CORK

Order of Operations & Table of Contents



OEM Pieces Removal

Section 1: Interior Disassembly
Section 2: OEM Spoiler Removal

Pg. 2
Pg. 3-4



CorkSport Spoiler Assembly

Section 3: CorkSport Spoiler Assembly

Pg. 5



Installation and Assembly

Section 4: Install the CorkSport Assembly

Pg. 7

Detailed Instructions

1. Interior Disassembly

- a) **Disconnect the trunk cover draw strings** and let the cover sit in the down position, shown with the **green circles** in **Figure 1a**.
- b) **Remove the center plastic panel**. The red dots show the locations of the snap clips holding the panel. Pop loose the outer clip first then pull the panel ends up slightly to release a hook clip. Then pop loose the inner snap clips. Shown in **Figure 1a**.



Figure 1a

- c) The results should look like **Figure 1b**.



Figure 1b

2. OEM Spoiler Removal

a) Disconnect the center brake light. Shown with the green circle in Figure 2a.

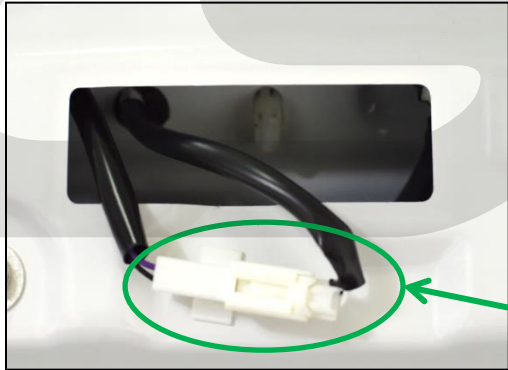
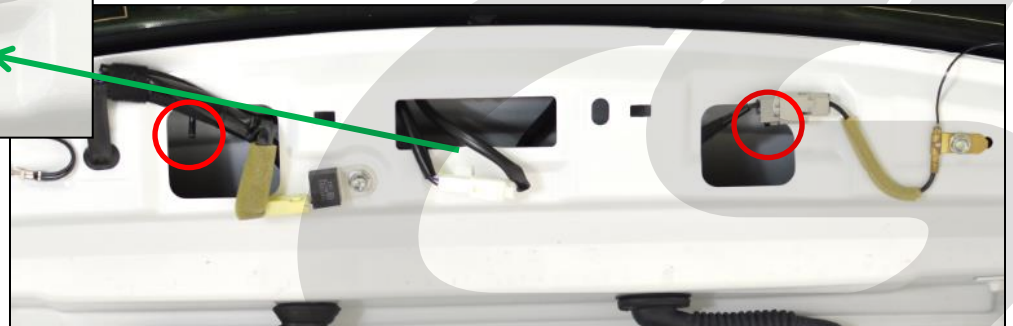

Figure 2a

b) Remove the nuts from the two studs circled in red in Figure 2a. Use a 10mm deep socket and wrench.



c) Remove the plugs on the left and right sides to access bolts. Use a 10mm socket and wrench to remove the bolts. Shown with the in Figure 2b.



Figure 2b



If you drop one of the nuts or bolts inside the trunk lid not all hope is lost. Use an extension rod with attached magnet to retrieve the nut. These can be purchased at your local auto parts store.

2. OEM Spoiler Removal (continued)

- d) **Remove the OEM spoiler.** The spoiler is attached to the car via snap clips located at the **red circles** in **Figure 2c**. Pop loose the two driver's side snap clips.

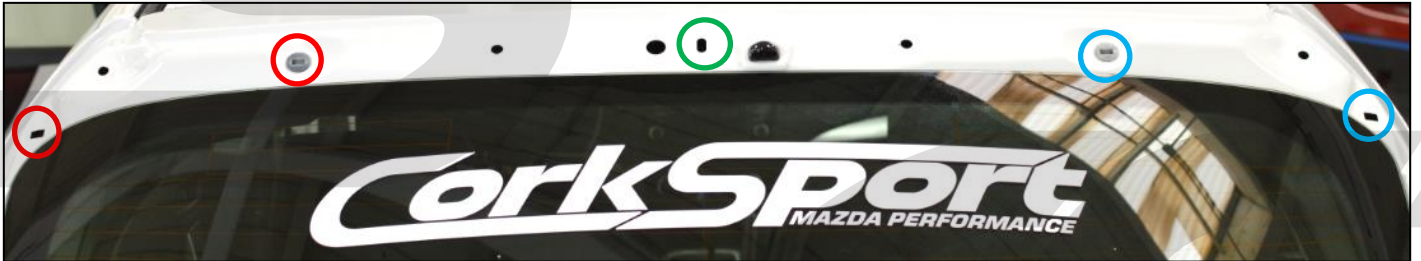

Figure 2c

- e) **Pop loose the center snap clip.** Use a flathead screwdriver to push the catch tabs to pop loose clip. **Red arrows** in **Figure 2d**. The tabs are on the top and bottom of the snap clip.

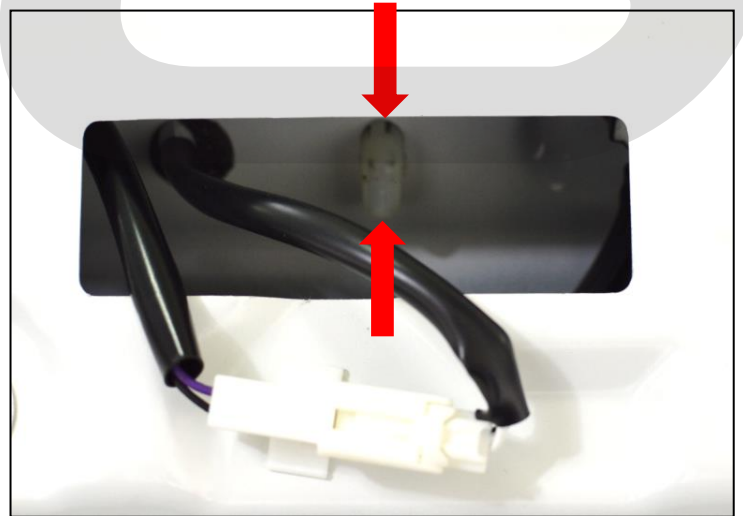

Figure 2d

- f) **Remove the passenger side snap clips.** While holding the spoiler up so the center snap clip will not refasten, shut the trunk lid. Then pop loose the passenger's side snap clips. **Blue circles** in **Figure 2c**.

3. CorkSport Spoiler Assembly

- a) **Remove the third brake light assembly from the OEM spoiler.** Remove the four phillips screws that hold the brake light assembly to the spoiler. Shown with **red arrows** in **Figure 3a**. (Two screws on each end)

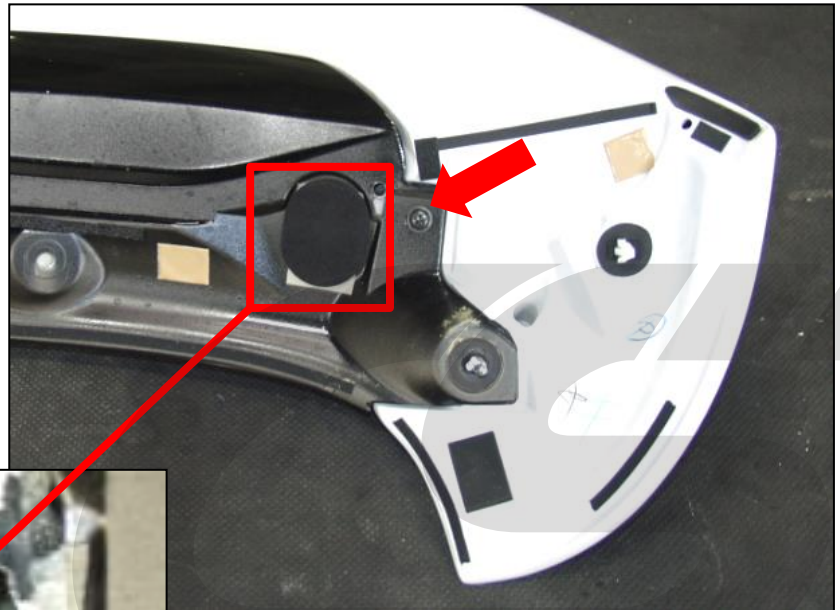

Figure 3a

- b) **Install the brake light assembly to the CorkSport spoiler.** Use the large round head philips screws that are provided. **Figure 3b**



Figure 3a

3. CorkSport Spoiler Assembly Continued

c) Install the provided 3M double sided tape as shown in Figure 3c. Leave the red 3M side attached. You will remove this later.

d) Trim the 3M tape with a razor blade to fit on the edges (Figure 3d).

e) Place the spoiler back on the car and check for overhang. Trim any excess tape.

f) Remove the red cover on the 3M double sided tape.



Figure 3c



Figure 3d

Detailed Instructions

4. Install the CorkSport Spoiler

- a) **Snap the spoiler into location.** Align the studs (**blue circles**) and snap clips (**red circles**) with their respective holes. Place the brake light wires through their respective hole (**green circle**).
Shown in **Figure 4a**.



The outer clips are not reused (Shown with **purple circles** in **Figure 4a**) . These are primarily for installation, not to hold the spoiler on.



Figure 4a

- b) **Install nuts and bolts to the spoiler.** For the inner studs, use the 10mm flange nuts provided. For the outer studs, use the 10mm flange bolt provided. Torque to 3-5 ft-lb.
- c) **Reconnect the third brake light wires.**
- d) **Snap the plastic panel back into place and connect the truck cover draw stings.**



This completes the installation of your CorkSport carbon fiber spoiler. Recheck the bolts after a week to make sure everything is still tight.

What's Next:

[CORKSPORT Mazdaspeed 3 TMIC Top Mount Intercooler](#)



The **CorkSport Top Mount Intercooler (TMIC)** provides **solid power gains and a great value** to the Mazdaspeed 3, MS6 and CX7 turbo. Made from CorkSport's own custom cast end tanks which are TIG welded to a 3" thick bar and plate core, the TMIC provides added performance by removing the bottleneck restriction of the stock intercooler and increasing resistance to heat soak by using thicker materials. The cold pipe connection is CNC milled and drilled for a leak proof connection and all bolt holes have been capped off.

[CorkSport Mazdaspeed 3 Cat Back Exhaust](#)

The **CorkSport Power Series Exhaust** for the 2010+ Mazdaspeed 3 provides noticeable power gains and solid value in an attractive and stylish part. Peak power gains for the exhaust system are 14 wheel horsepower. The CorkSport exhaust features 80mm exhaust piping, a straight through high flow muffler, and a 4 inch rolled stainless steel exhaust tip which all combine to give the Mazdaspeed 3 a powerful presence. The exhaust produces a very distinct, deep sound from the 2.3 DISI Turbo engine used in the 2010+ Mazdaspeed 3.

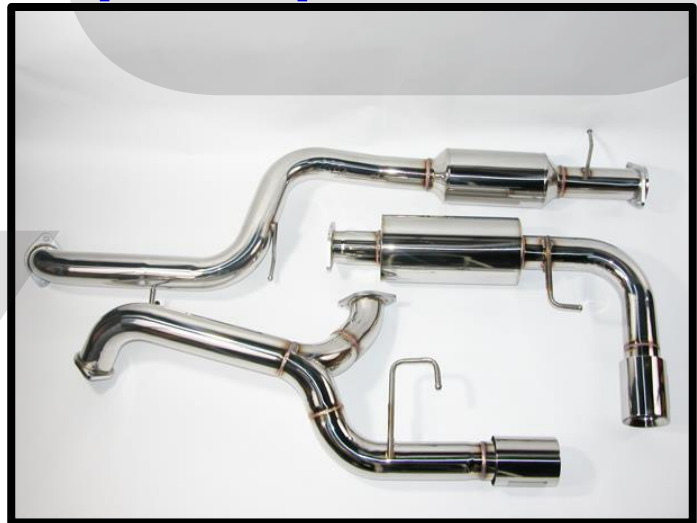

[CorkSport DISI Silicone Bypass Valve Hose](#)



CorkSport now offers the Power Series Bypass Valve Hose specifically designed and tested for the Mazda MZR DISI Turbo engine. The hose is a clamp-in replacement for the stock non-reinforced rubber hose. Install the hose to complete your engine bay colors and match the CorkSport SRI silicone connectors and Boost Tubes. The bypass hose is a 5 layer silicone part that contains 4 layers of reinforcement for a strong, yet flexible connection which allows for ideal flow from the bypass valve to the turbo inlet pipe.