

1. Print a copy of the drawing, making sure that the “Size Options” is set at “Actual Size” (or make sure “Scale” is at “100%”)

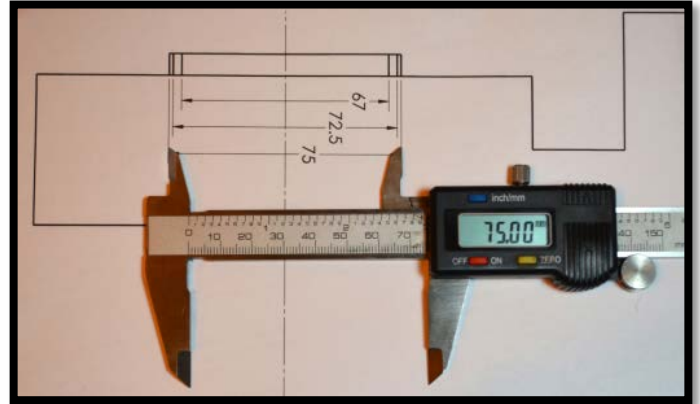

2. Check dimensions to confirm it has been printed to scale.

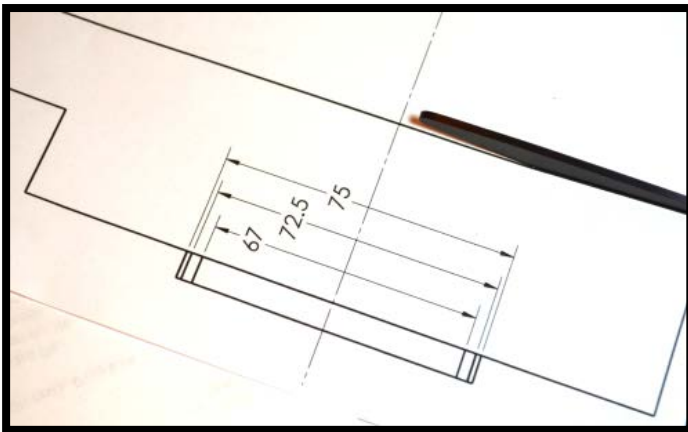

3. Cut the drawing just outside the line. Cut down to hub size of wheel.

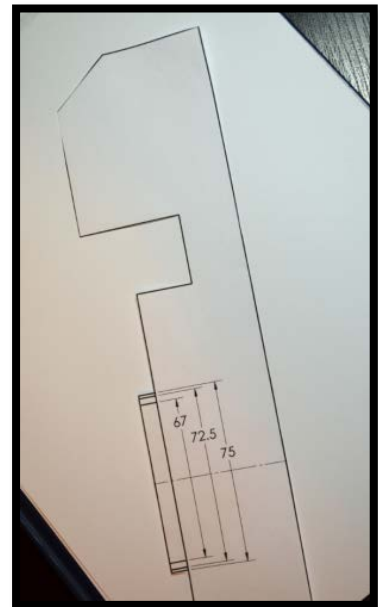

4. Glue the drawing to a stiffer piece of material such as a manila folder to make the template easier to use. Finish by cutting directly along the line.

PART#: AXL-3-412

Need Help With Your Installation? Call (360) 260-CORK



*We absolutely, positively,
deliver - every time.*

CORKSPORT.COM



5. Lay the template inside the wheel as shown. Verify that the edge of the caliper does not touch the rim or the wheel spokes. A minimum clearance of 2mm (0.080") is recommended.



If there is interference, different wheels or a spacer will be necessary. Use of a wheel spacer is at the discretion of the vehicle owner. Typically a properly made spacer of 2-3mm will not adversely affect the vehicle. Issues that must be addressed before utilizing a wheel spacer include, but are not limited to, fender clearance, proper wheel bolt or stud length, effect on vehicle handling, and centering of the wheel. Wheel fitment and the use of wheel spacers with our brake caliper upgrade is the responsibility of the customer.

PART#: AXL-3-412

Need Help With Your Installation? Call (360) 260-CORK



*We absolutely, positively,
deliver - every time.*

CORKSPORT.COM

